

Knife gate valve with electric actuator interflange

PN10
PN16

SEWAGE



Product description (standard execution):

- Bidirectional tightness
- Knife circumferential seal profile with steel insert
- Knife cleaning scrapers
- Ductile cast iron monolithic body EN-GJS 400-15
- Stainless steel 1.4021 spindle with rolled thread
- Low friction spindle bearing by plastic and brass plain washers
- Gland sealing – o-ring NBR and non-asbestos cord
- Spindle nut made of bronze
- Epoxy coating minimum 250 microns according to EN 14901
- Stainless steel bolts and washers
- Product according to EN 1074-1, EN 1074-2; EN 1171
- Flange connection according to EN 1092-2 (DIN 2501) pressure PS2,5; PS6; PS10
- ISO top flange 5211
- Face to face according to producer documentation JAFAR
- Product marking according to EN 19; EN 1074

Application:

Water and sewage networks and tanks; pulverized products, transport of non aggressive liquids.
Working conditions:
temp. up +70°C
pressure up to 1,0 MPa

Test control:

Hydraulic test according to EN 1074-1; EN 1074-2; EN 12266-1
Seat: 1,1 xPN
Body: 1,5 x PN
Operation torque test.

Installation:

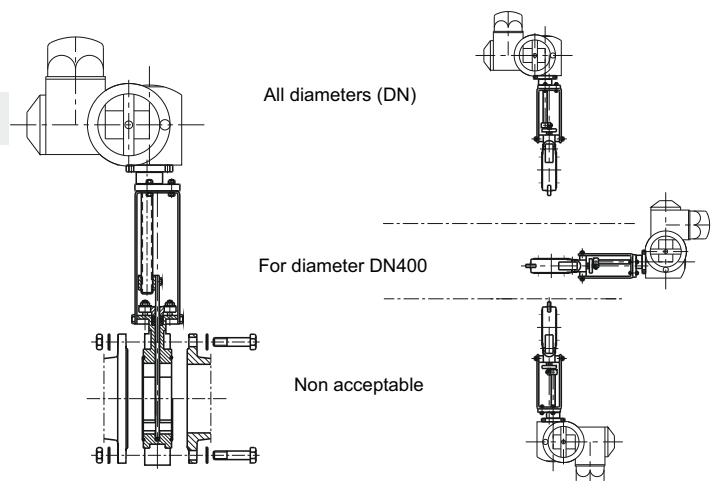

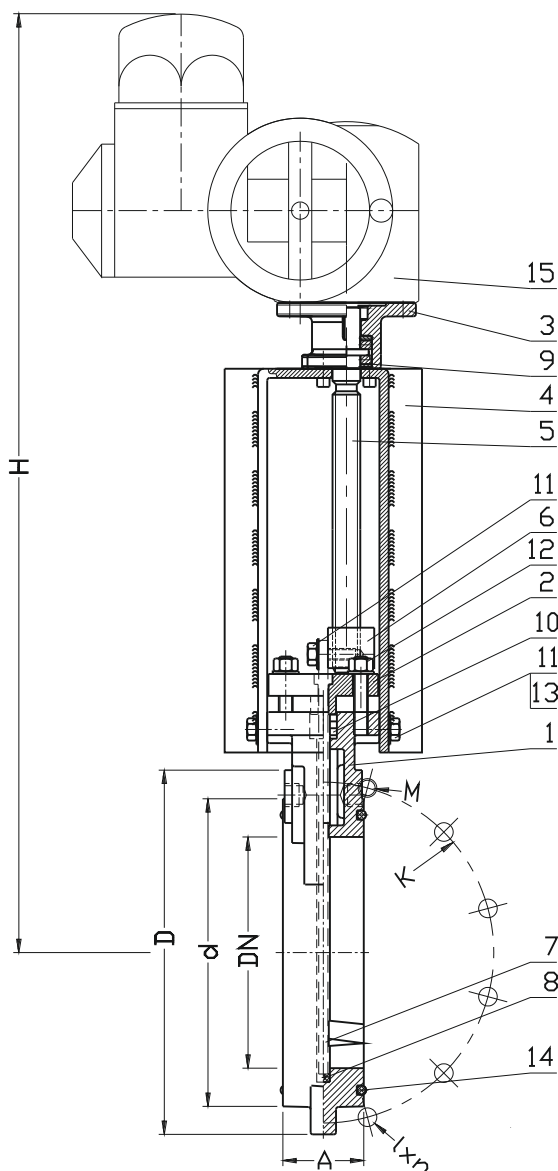

Standard: DN50 to DN400 - non-rising or rising spindle
DN500 to DN1000 - rising spindle

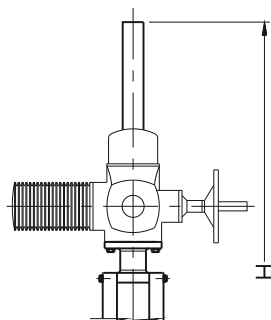

Standard: DN500 to DN1000 -
- rising spindle

| No | Part | Standard execution |
|---|-------------------|---|
| 1 | Body | Ductil cast iron EN-GJS-400-15 EN 1563 |
| 2 | Clamping plate | Ductil cast iron EN-GJS-400-15 EN 1563 |
| 3 | Engine base | Ductil cast iron EN-GJS-400-15 EN 1563 |
| 4 | Pillar | Steel 1.0038 EN 10025-2 |
| 5 | Spindle | Stainless steel 1.4021, 1.4301 (*), 1.4462 (*) EN 10088-1 |
| 6 | Spindle nut | Bronze CW306G EN 1412 |
| 7 | Knife | Stainless steel 1.4301, 1.4404 (*) EN 10088-1 |
| 8 | Gasket | Rubber NBR EN-ISO 1629 |
| 9 | Sliding bushing | Producer catalogue |
| 10 | Gland seal | PACKAGE: rubber NBR, EN-ISO 1629 + with non-asbestos cord |
| 11 | Screw | Stainless steel A2, A4 (*) EN ISO 4014 |
| 12 | Nut | Stainless steel A4 EN ISO 4032 |
| 13 | Washer | Stainless steel A2 EN ISO 7091 |
| 14 | Seal o-ring | Rubber NBR EN-ISO 1629 |
| 15 | Electric actuator | Producer catalogue |
| (*) -other material variants on special request | | |

| DN | PN | PS | K | D | d | I x n | M x n | A | H | Actuator | Flange connections | Turn for full open | Weight |
|------|-------|-----|------|------|------|--------|--------|----------|---------------------|----------|--------------------|--------------------|--------|
| [mm] | [bar] | | | | | [mm] | | vg. rys. | rising (non-rising) | | | | [kg] |
| 50 | 16 | 10 | 125 | 165 | 99 | - | M16x4 | 48 | 551 | SA 7.2 | F10 | 14 | 25 |
| 65 | 16 | 10 | 145 | 185 | 118 | - | M16x4 | 48 | 582 | SA 7.2 | F10 | 18 | 29 |
| 80 | 16 | 10 | 160 | 200 | 132 | Ø19x6 | M16x2 | 52 | 598 | SA 7.2 | F10 | 22 | 30 |
| 100 | 16 | 10 | 180 | 220 | 156 | Ø19x6 | M16x2 | 52 | 632 | SA 7.2 | F10 | 27 | 32 |
| 125 | 16 | 10 | 210 | 250 | 184 | Ø19x6 | M16x2 | 56 | 684 | SA 7.2 | F10 | 33 | 38 |
| 150 | 16 | 10 | 240 | 285 | 212 | Ø23x6 | M20x2 | 56 | 740 | SA 7.6 | F10 | 32 | 41 |
| 200 | 10 | 10 | 295 | 340 | 266 | Ø23x6 | M20x2 | 70 | 830 | SA 7.6 | F10 | 42 | 58 |
| 250 | 10 | 10 | 350 | 395 | 319 | Ø23x8 | M20x4 | 70 | 930 | SA 10.2 | F10 | 52 | 72 |
| 300 | 10 | 10 | 400 | 445 | 370 | Ø23x8 | M20x4 | 76 | 1100 | SA 10.2 | F10 | 62 | 86 |
| 350 | 10 | 10 | 460 | 505 | 430 | Ø23x10 | M20x6 | 76 | 1180 | SA 10.2 | F10 | 72 | 106 |
| 400 | 10 | 10 | 515 | 565 | 480 | Ø28x10 | M24x6 | 86 | 1286 | SA 10.2 | F10 | 68 | 146 |
| 500 | 10 | 6 | 620 | 670 | 582 | Ø28x12 | M24x8 | 114 | 1560(1760) | SA 14.6 | F14 | 85 | 282 |
| 600 | 10 | 6 | 725 | 780 | 682 | Ø31x12 | M27x8 | 114 | 1785(2100) | SA 14.6 | F14 | 102 | 332 |
| 700 | 10 | 2,5 | 840 | 895 | 794 | Ø31x14 | M27x10 | 165 | 2500 | SA 16.2 | F16 | 118 | 637 |
| 800 | 10 | 2,5 | 950 | 1015 | 901 | Ø34x14 | M30x10 | 190 | 2260(2860) | SA 16.2 | F16 | 116 | 763 |
| 900 | 10 | 2,5 | 1050 | 1115 | 1001 | Ø34x16 | M30x12 | 203 | 3070 | SA 16.2 | F16 | 115 | 933 |
| 1000 | 10 | 2,5 | 1160 | 1230 | 1112 | Ø37x16 | M33x12 | 216 | 3650(3430) | SA 16.2 | F16 | 127 | 1233 |

We reserve the rights to modify the production program and the given data without separate notices due to the permanent company development.