

Resilient seated Gate valve with ISO/2"
fitting for PE pipe

PN16

WATER

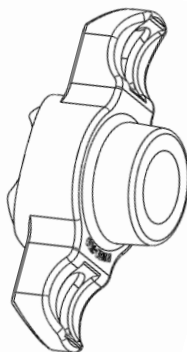
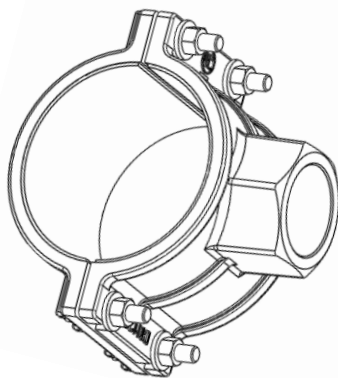

Gate valve DN32 ISO40/2"

Product description (standard execution):

- Body bonnet and wedge made of ductile cast iron EN-GJS 400-15
- POM tube clamping ring protection against slipping
- Full bore gate valve
- Outside and inside full vulcanized wedge by EPDM; made of brass EN 1412
- Forged replaceable wedge nut made of brass for gate valve DN40 and DN50
- Stainless steel spindle with rolled thread
- Low friction double spindle bearing both horizontal and vertical way
- O-ring spindle sealing packing cork protected against medium
- Under pressure replaceable packing cork
- Forged packing cork protected against unscrewing
- Packing cork protected against dirt penetration
- Body bonnet Zinc coated screws protected by wax
- Epoxy coating minimum 250 microns according to EN 14901 GSK RAL certificate
- Article according to EN 1074-1, EN 1074-2
- Face to face according to producer documentation JAFAR
- Product marking according to EN 19; EN 1074

Application:

Water networks and tanks. Transport of non aggressive liquids.
Working conditions:
temp. up +70°C
pressure up to 1,6 MPa

Test control:

Hydraulic test according to EN 1074-1, EN 1074-2; EN 12266-1
Seat 1,1 x PN
Body 1,5 x PN
Operation torque test

Accessories:

Extension spindle - see: 9010, 9011
Welt for ISO connections - see: 9306
Street box - see: 9501 9503 9504 9509

Execution variant:

Ductile cast iron EN-GJS 500-7
SS body bonnet screws

Installation:

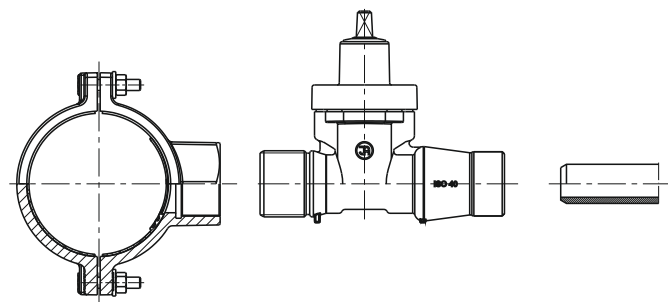

For diameters DN20 - DN32

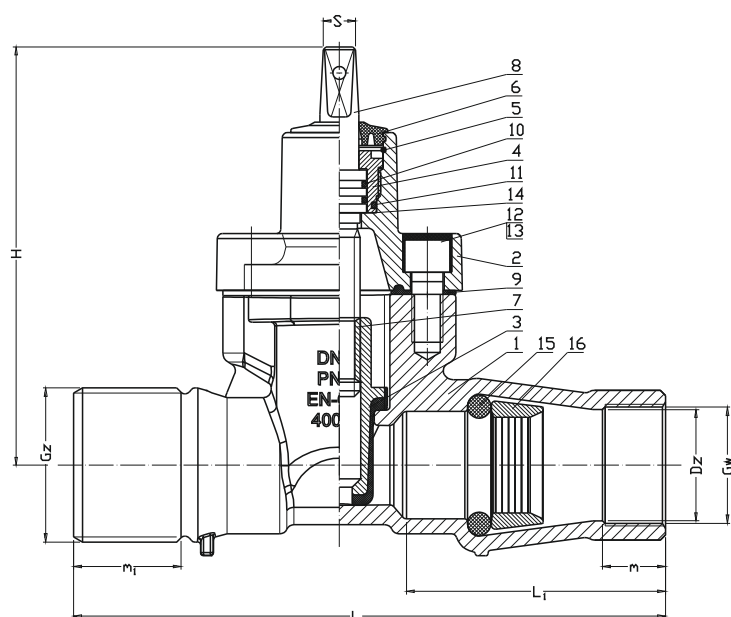

For diameters DN40 - DN50

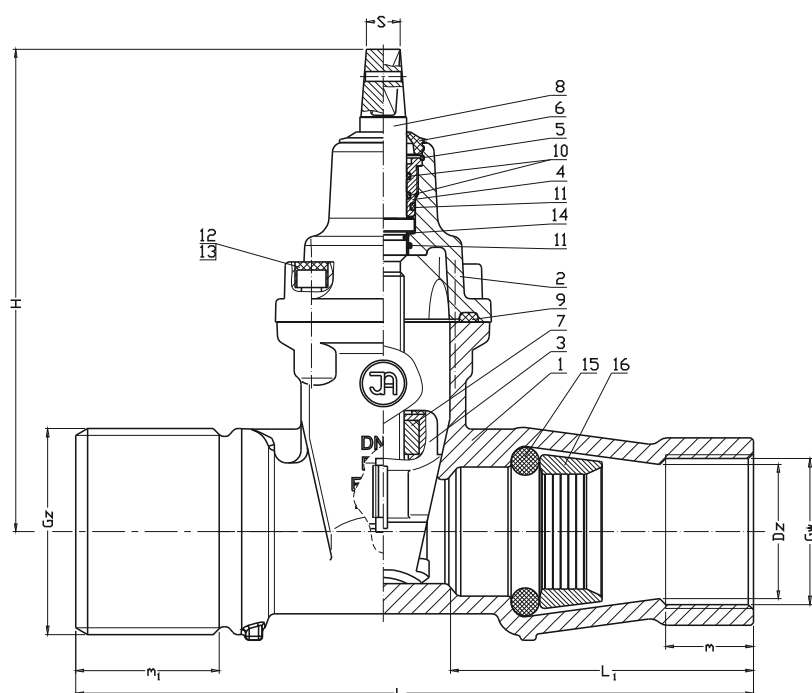

No.	Part	Standard execution
1	Body	Ductile cast iron EN-GJS 400-15 EN 1560
2	Bonnet	Ductile cast iron EN-GJS 400-15 EN 1560
3	Wedge	Brass CW617N, CW509L(*), Cw510L(*) (DN20-DN32) EN 1412 Ductile cast iron(DN40-DN50) EN-GJS-400-15 EN 1560 Rubber EPDM, NBR(*) EN ISO 1629
	Wedge slider	Poliacetal POM-K EN ISO 29988-1
4	Packing cork	Brass CW617N, CW509L(*), Cw510L(*) EN 1412
5	Protection ring	Steel 1.4310 EN 10027-2
6	Cleaning gasket	Rubber EPDM, NBR(*) EN ISO 1629
7	Spindle nut	Brass CW617N, CW509L(*), Cw510L(*) (DN40-DN50) EN 1412
8	Spindle	Stainless steel 1.4021 EN 10027-2
9	Body-bonnet gasket	Rubber EPDM, NBR(*) EN ISO 1629
10	O-ring	Rubber EPDM, NBR(*) EN ISO 1629
12	Screw	Steel Fe/Zn, Stainless steel A2 EN ISO 4762
13	Srew stopper	Wax
14	Washer	Poliacetal POM-K EN ISO 29988-1
15	Gasket	Rubber EPDM, NBR(*) EN ISO 1629
16	Tension ring	Poliacetal POM-K EN ISO 29988-1
(*) - other material variants on special request		

DN	Dz	PN	Gz	Gw	H	L	L ₁	m	m ₁	S	Weight
[mm]	[mm]	[bar]	["]				[mm]				[kg]
25	32	16	2	1 1/4	160	207	91	25	40	12	2,8
32	40	16	2	1 1/2	160	220	102	30	40	12	4,3
40**	50	16	2	2	215	250	115	30	40	14	7,2
50**	63	16	2	2 1/2	225	280	125	30	40	14	8,8

** during commissioning

We reserve the rights to modify the production program and the given data without separate notices due to the permanent company development.