

Concentric butterfly valve
LUG

PN10
PN16

WATER



Butterfly valve DN100

Product description (standard execution):

- Concentric disc made of stainless steel 1.4301 or ductile cast iron
- EPDM, NBR replaceable loose liner protected against axial displacement
- Stainless steel 1.4021 solid spline (not pinned) shaft with the bottom side seated in blind hole of the body
- Three-slide bearings
- Special shaped loose liner to seal with the shaft crossing
- Additional shaft sealing made of EPDM, NBR o-rings
- Body made of cast iron EN-GJS 400-15
- With lock lever up to DN200 over with gear box
- For DN350 splined connection from DN400 with pin connections
- Actuator connector according to ISO 5211 (ISO top flange)
- Epoxy coating to EN 14901
- End connection according to EN 1092-2 (DIN 2501), pressure PN10; PN16
- Face to face according to EN 558-A1 row 20 (DIN 3202)
- Product according to EN 1074-1; EN 1074-2; EN-593
- Product marking according to : EN 19; EN 1074

Application:

Water network and tanks. Transport of industrial water and non aggressive liquids.
Working conditions:
temp. up to +70 °C
pressure up to 1.6 MPa.

Test control:

Hydraulic test according to EN 1074-1; EN 1074-2; EN 12266-1
Seat: 1,1 xPN
Body: 1,5 x PN
Operation torque test.

Accessories:

Extension spindle - see: 9010, 9011
Pillar with handwheel - see: 9113
Pillar for electric actuator - see: 9114
Street box - see: 9501

Execution variant:

With lever for DN200
With Gear box from DN250
With electric or pneumatic actuator
For extension spindle

Installation:

Up to DN250 in any position. Over DN250 actuator from the side shaft in horizontal position.

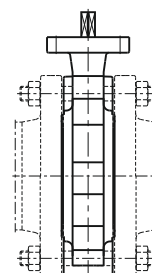

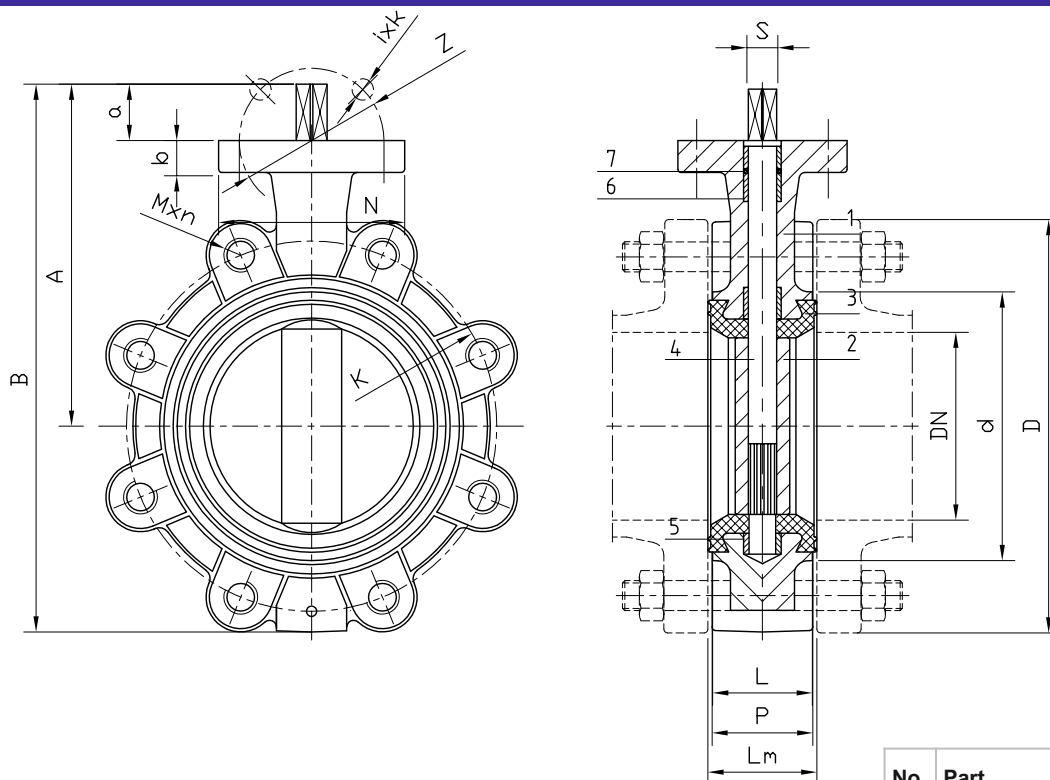

| No. | Part | Standard execution |
|--|--------|--|
| 1 | Body | Ductile cast iron EN-GJS-400-15 EN 1563 |
| 2 | Disc | Ductile cast iron EN-GJS-400-15 EN 1563 Stainless steel 1.4301(*) EN 10088-1 |
| 3 | Ring | Rubber EPDM, NBR(*) EN ISO 1629 |
| 4 | Shaft | Stainless steel 1,4021 EN 10088-1 |
| 5,6 | Sleeve | Brass CW617N EN 12165 PTFE(*) |
| 7 | O-ring | Rubber EPDM, NBR(*) EN ISO 1629 |
| (*) - other material variants on special request | | |

| DN | PN | L | Lm | P | A | B | d | D PN10 | D PN16 | K PN10 | K PN16 | M PN10 | M PN16 | n PN10 | n PN16 | i | k | N | z | S | a | Weight |
|------|-------|-----|-----|-----|-----|------|------|-----------|-----------|-----------|-----------|-----------|-----------|-----------|-----------|---|----|-----|-----|----|----|--------|
| [mm] | [bar] | | | | | | [mm] | | | | | | | [szt] | | | | | | | | [kg] |
| 40 | 10/16 | 33 | 36 | 30 | 121 | 183 | 76 | 150 | 150 | 110 | 110 | M16 | M16 | 4 | 4 | 4 | 7 | 70 | 50 | 11 | 28 | 3,2 |
| 50 | 10/16 | 43 | 46 | 40 | 137 | 203 | 92 | 165 | 165 | 125 | 125 | M16 | M16 | 4 | 4 | 4 | 7 | 70 | 50 | 11 | 28 | 4,4 |
| 65 | 10/16 | 46 | 49 | 43 | 150 | 228 | 106 | 185 | 185 | 145 | 145 | M16 | M16 | 4 | 4 | 4 | 7 | 70 | 50 | 11 | 28 | 5,8 |
| 80 | 10/16 | 46 | 49 | 42 | 160 | 245 | 114 | 200 | 200 | 160 | 160 | M16 | M16 | 8 | 8 | 4 | 9 | 90 | 70 | 11 | 30 | 7,1 |
| 100 | 10/16 | 52 | 55 | 47 | 182 | 280 | 143 | 220 | 220 | 180 | 180 | M16 | M16 | 8 | 8 | 4 | 9 | 90 | 70 | 14 | 30 | 8,1 |
| 125 | 10/16 | 56 | 59 | 54 | 207 | 328 | 170 | 250 | 250 | 210 | 210 | M16 | M16 | 8 | 8 | 4 | 9 | 90 | 70 | 14 | 30 | 20,5 |
| 150 | 10/16 | 56 | 59 | 54 | 223 | 357 | 203 | 285 | 285 | 240 | 240 | M20 | M20 | 8 | 8 | 4 | 9 | 90 | 70 | 17 | 30 | 23 |
| 200 | 10/16 | 60 | 63 | 57 | 255 | 418 | 252 | 340 | 340 | 295 | 295 | M20 | M20 | 8 | 12 | 4 | 9 | 90 | 70 | 17 | 30 | 27 |
| 250 | 10/16 | 68 | 72 | 65 | 314 | 510 | 306 | 395 | 405 | 350 | 355 | M20 | M24 | 12 | 12 | 4 | 12 | 125 | 102 | 22 | 40 | 41 |
| 300 | 10/16 | 78 | 82 | 75 | 342 | 564 | 364 | 445 | 460 | 400 | 410 | M20 | M24 | 12 | 12 | 4 | 12 | 125 | 102 | 22 | 45 | 56 |
| 350 | 10/16 | 78 | 82 | 74 | 365 | 640 | 431 | 505 | 520 | 460 | 470 | M20 | M24 | 16 | 16 | 4 | 14 | 125 | 102 | 22 | 45 | 82 |
| 400 | 10/16 | 102 | 106 | 96 | 410 | 725 | 480 | 565 | 580 | 515 | 525 | M24 | M27 | 16 | 16 | 4 | 14 | 175 | 140 | 27 | 60 | 134 |
| 500 | 10/16 | 127 | 131 | 120 | 490 | 866 | 590 | 670 | 715 | 620 | 650 | M24 | M30 | 20 | 20 | 4 | 22 | 175 | 140 | 36 | 65 | 191 |
| 600 | 10/16 | 154 | 158 | 144 | 565 | 1031 | 688 | 780 | 840 | 725 | 770 | M27 | M33 | 20 | 20 | 4 | 22 | 210 | 165 | 36 | 65 | 266 |

We reserve the rights to modify the production program and the given data without separate notices due to the permanent company development.