

Concentric butterfly valve wafer

PN10
PN16

WATER



Centric butterfly valve DN80 with lever



Centric butterfly valve DN250 with gear box

Product description (standard execution):

- Concentric disc made of stainless steel 1.4401 or ductile cast iron
- EPDM, NBR replaceable loose liner protected against axial displacement
- Stainless steel 1.4021 solid spline (not pinned) shaft with the bottom side seated in blind hole of the body
- Three-slide bearings
- Special shaped loose liner to seal with the shaft crossing
- Additional shaft sealing made of EPDM, NBR o-rings
- Body made of cast iron EN-GJS 400-15
- With lock lever up to DN200 over with gear box
- For DN350 splined connection from DN400 with pin connections
- Actuator connector according to ISO 5211 (ISO top flange)
- Epoxy coating to EN 14901
- End connection according to EN 1092-2 (DIN 2501), pressure PN10; PN16
- Face to face according to EN 558-A1 row 20 (DIN 3202)
- Product according to EN 1074-1; EN 1074-2; EN-593
- Product marking according to : EN 19; EN 1074

Application:

Water network and tanks. Transport of industrial water and non aggressive liquids.
Working conditions:
temp. up to +70°C
pressure up to 1.6 MPa.

Test control:

Hydraulic test according to EN 1074-1; EN 1074-2; EN 12266-1
Seat: 1,1 xPN
Body: 1,5 x PN
Operation torque test.

Accessories:

Extension spindle - see: 9010, 9011
Pillar with handwheel - see: 9113
Pillar for electric actuator - see: 9114
Street box - see: 9501

Execution variant:

With lever for DN200
With Gear box from DN250
With electric or pneumatic actuator
For extension spindle

Installation:

DN40-DN250 in any position. Over DN250 shaft in horizontal position

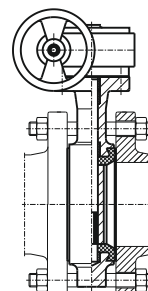

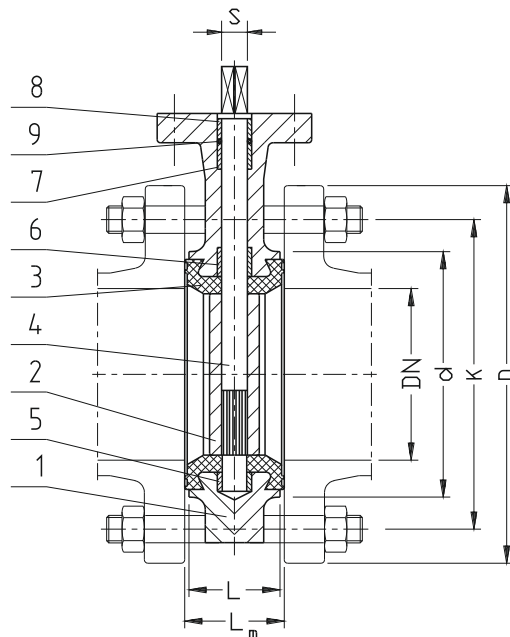
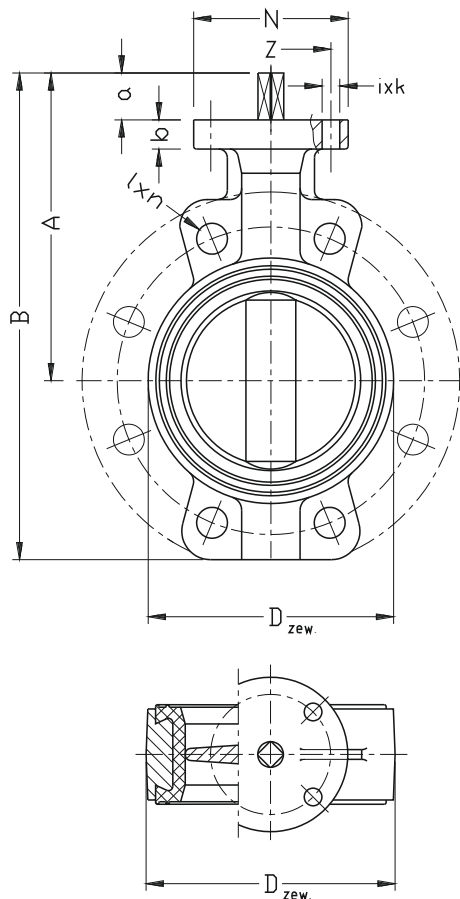

No.	Part	Standard execution
1	Body	Ductile cast iron EN-GJS 400-15 EN 1560
2	Disc	Ductile cast iron EN-GJS 400-15 EN 1560 Stainless steel 1.4401(*) EN 10027-2
3	Ring	Rubber EPDM, NBR(*) EN ISO 1629
4	Shaft	Stainless steel 1.4021 EN 10027-2
5,6 7,8	Sleeve	Brass CW617N EN 1412 PTFE(*)
9	O-ring	Rubber EPDM, NBR(*) EN ISO 1629
(*) - other material variants on special request		

DN	PN			L	Lm	A	B	D _{zew.}	d	D PN10	D PN16	K PN10	K PN16	I PN10	I PN16	n PN10	n PN16	ISO 5211	l x k	N	z	S	a	Masa
	10	16	10/16																					
[mm]	[bar]			[mm]												[szt]		-	[mm]					[kg]
40	-	-	v	33	36	121	176	76	76	150	150	110	110	19	19	4	4	F05	4x7	65	50	11	28	3
50	-	-	v	43	45	137	222	97	92	165	165	125	125	19	19	4	4	F05	4x7	65	50	11	28	4
65	-	-	v	46	49	150	235	108	106	185	185	145	145	19	19	4	4	F05	4x7	65	50	11	28	5
80	-	-	v	46	49	160	245	127	114	200	200	160	160	19	19	8	8	F05	4x7	65	50	11	30	7
100	-	-	v	52	55	182	280	160	143	220	220	180	180	19	19	8	8	F07	4x9	90	70	14	30	8
125	-	-	v	56	59	207	328	188	170	250	250	210	210	19	19	8	8	F07	4x9	90	70	14	30	8
150	-	-	v	56	59	223	357	210	203	285	285	240	240	23	23	8	8	F07	4x9	90	70	17	30	13
200	-	-	v	60	63	255	418	270	252	340	340	295	295	23	23	12	12	F10	4x12	125	102	17	30	20
250	-	-	v	68	72	314	510	331	306	395	405	350	355	23	28	12	12	F10	4x12	125	102	22	40	29
300	-	-	v	78	82	342	564	372	364	445	460	400	410	23	28	12	12	F10	4x12	125	102	22	45	40
350	-	-	v	78	82	365	640	414	431	505	520	460	470	23	28	16	16	F10	4x12	125	102	22	45	47
400	-	-	v	102	106	410	725	488	480	565	580	515	525	28	31	16	16	F14	4x18	175	140	27	60	98
450	-	-	v	114	118	451	775	536	525	615	640	565	585	28	31	20	20	F14	4x18	175	140	27	60	127
500	-	-	v	127	131	490	866	593	590	670	715	620	650	28	34	20	20	F14	4x18	175	140	36	65	185
600	-	-	v	154	158	565	1031	825	688	788	840	725	770	31	37	20	20	F16	4x22	210	165	36	66	275
700	v	v	-	165	169	610	1120	927	800	895	910	840	840	31	37	24	24	F25	8x18	300	254	46	66	394
800	v	v	-	190	196	738	1314	1060	900	1015	1025	950	950	34	41	24	24	F25	8x18	300	254	46	66	506
900	v	v	-	203	208	838	1475	-	1000	1115	1125	1050	1150	34	41	28	28	F25	8x18	300	254	55	118	756
1000	v	v	-	216	223	942	1643	-	1120	1230	1255	1160	1170	37	44	28	28	F25	8x18	300	254	55	142	804
1200	v	v	-	254	263	1090	1934	-	1300	1455	1485	1380	1390	41	50	32	32	F30	8x22	350	298	-	150	1251

We reserve the rights to modify the production program and the given data without separate notices due to the permanent company development.