

**Concentric butterfly valve with electric actuator
wafer**

PN10
PN16

WATER



Centric butterfly valve DN200

Product description (standard execution):

- Concentric disc made of stainless steel 1.4401 or ductile cast iron
- EPDM, NBR replaceable loose liner protected against axial displacement
- Stainless steel 1.4021 solid spline (not pinned) shaft with the bottom side seated in blind hole of the body
- Three-slide bearings
- Special shaped loose liner to seal with the shaft crossing
- Additional shaft sealing made of EPDM, NBR o-rings
- For DN350 splined connection from DN400 with pin connections
- Body made of ductile cast iron EN-GJS 400-15
- Actuator connector according to ISO 5211 (ISO top flange)
- Epoxy coating to EN 14901
- End connection according to EN 1092-2 (DIN 2501) pressure PN10; PN16
- Face to face according to EN 558-A1 row20 (DIN 3202)
- Product according to EN 1074-1; EN 1074-2; EN-593
- Product marking according to : EN 19, EN 1074

Application:

Water network and tanks. Transport of industrial water and non aggressive liquids.

Working conditions:
temp. up to +70°C
pressure up to 1.6 MPa.

Test control:

Hydraulic test according to EN 1074-1; EN 1074-2; EN 12266-1
Seat: 1,1 xPN
Body: 1,5 x PN

Installation:

Actuator from the side. Shaft in horizontal position.

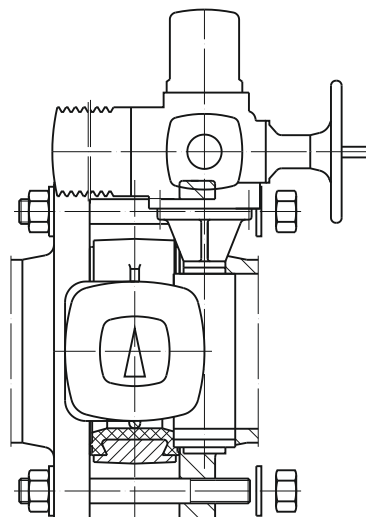

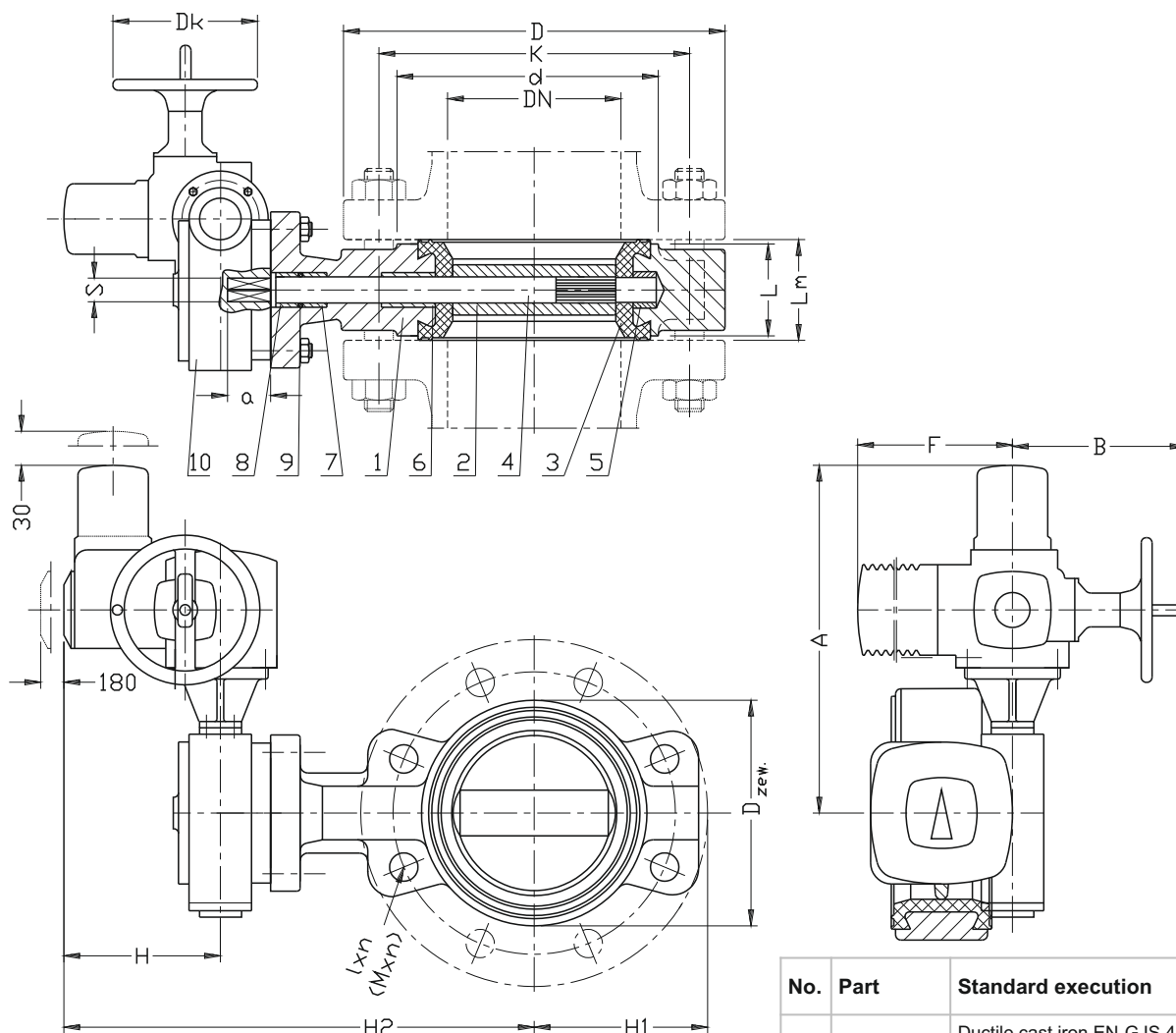

No.	Part	Standard execution
1	Body	Ductile cast iron EN-GJS 400-15 EN 1560
2	Disc	Ductile cast iron EN-GJS 400-15 EN 1560 Stainless steel 1.4401(*) EN 10027-2
3	Ring	Rubber EPDM, NBR(*) EN ISO 1629
4	Shaft	Stainless steel 1.4021 EN 10027-2
5,6 7,8	Sleeve	Brass CW617N EN 1412 PTFE(*)
9	O-ring	Rubber EPDM, NBR(*) EN ISO 1629
10	Electric actuator	Producer catalogue
(*) - other material variants on special request		

DN	PN	L	Lm	A	B	d	D _{zew.}	D	D	K	K	I	I	n	n	ISO	F	H	H1	H2	S	a
[mm]	[bar]							PN10	PN16	PN10	PN16	PN10	PN16	PN10	PN16	5211						
								[mm]						[szt]		-	[mm]					
400	10/16	102	106	405	254	480	488	565	580	515	525	28	31	16	16	F14	282	354	298	754	27	60
500	10/16	127	131	535	254	590	593	670	715	620	650	28	34	20	20	F14	282	390	355	870	36	65
600	10/16	154	158	535	254	688	825	788	840	725	770	31	37	20	20	F16	282	390	464	952	36	66
700	10/16	165	169	539	254	800	927	895	910	840	840	31	37	24	24	F25	282	392	505	1016	46	66
800	10/16	190	195	615	254	900	1060	1015	1025	950	950	34	41	24	24	F25	282	417	576	1089	46	66
900	10/16	203	208	700	254	1000	-	1115	1125	1050	1150	34	41	28	28	F25	282	458	638	1178	55	118
1000	10/16	216	223	700	254	1120	-	1230	1255	1160	1170	37	44	28	28	F25	282	458	700	1258	55	142
1200	10/16	254	263	795	329	1300	-	1455	1485	1380	1390	41	50	32	32	F30	384	545	844	1485	-	150

We reserve the rights to modify the production program and the given data without separate notices due to the permanent company development.