

**Concentric butterfly valve with electric actuator  
wafer**

PN10  
PN16

**WATER**



Centric butterfly valve DN200+SQ07+AUTOMATIC 01.2



Centric butterfly valve DN300 +SQ10.2

## Product description (standard execution):

- Concentric disc made of stainless steel 1.4401 or ductile cast iron
- EPDM, NBR replaceable loose liner protected against axial displacement
- Stainless steel 1.4021 solid spline (not pinned) shaft with the bottom side seated in blind hole of the body
- Three-slide bearings
- Special shaped loose liner to seal with the shaft crossing
- Additional shaft sealing made of EPDM, NBR o-rings
- For DN350 splined connection from DN400 with pin connections
- Body made of ductile cast iron EN-GJS 400-15
- Actuator connector according to ISO 5211 (ISO top flange)
- Epoxy coating to EN 14901
- End connection according to EN 1092-2 (DIN 2501) pressure PN10; PN16
- Face to face according to EN 558-A1 row20 (DIN 3202)
- Product according to EN 1074-1; EN 1074-2; EN-593
- Product marking according to : EN 19, EN 1074

## Application:

Water network and tanks. Transport of industrial water and non aggressive liquids.

Working conditions:  
temp. up to +70°C  
pressure up to 1.6 MPa.

## Test control:

Hydraulic test according to EN 1074-1; EN 1074-2; EN 12266-1  
Seat: 1,1 xPN  
Body: 1,5 x PN  
Operation torque test.

## Installation:

DN40-DN250 in any position. Over DN250 actuator from the side. Shaft in horizontal position.

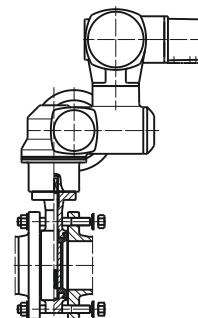

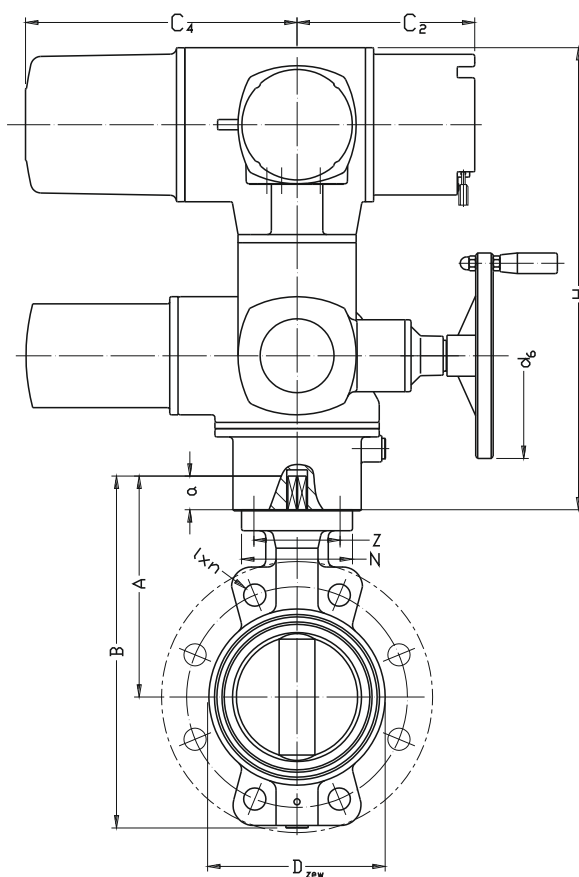
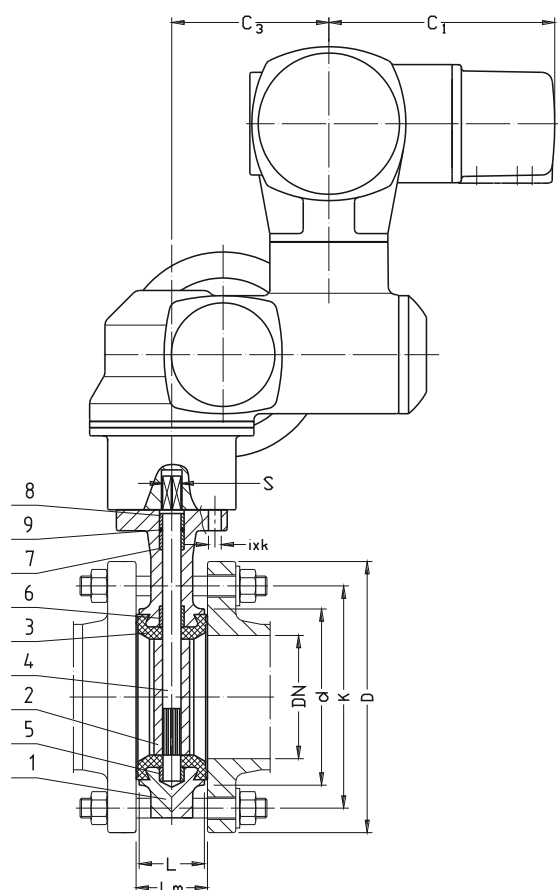

No.	Part	Standard execution
1	Body	Ductile cast iron EN-GJS 400-15 EN 1560
2	Disc	Ductile cast iron EN-GJS 400-15 EN 1560 Stainless steel 1.4401(*) EN 10027-2
3	Ring	Rubber EPDM, NBR(*) EN ISO 1629
4	Shaft	Stainless steel 1.4021 EN 10027-2
5,6 7,8	Sleeve	Brass CW617N EN 1412 PTFE(*)
9	O-ring	Rubber EPDM, NBR(*) EN ISO 1629
(*) - other material variants on special request		

DN	PN	L	Lm	A	B	D <sub>zew</sub>	d	D	D	K	K	I	I	n	n	ISO	I x k	N	z	S	a	C1	C2	C3	C4	H
[mm]	[bar]																									
40	10/16	33	36	121	176	76	76	150	150	110	110	19	19	4	4	F05	4x7	90	50	11	28	220	171	143	265	434
50	10/16	43	45	137	222	97	92	165	165	125	125	19	19	4	4	F05	4x7	90	50	11	28	220	171	143	265	434
65	10/16	46	49	150	235	108	106	185	185	145	145	19	19	4	4	F05	4x7	90	50	11	28	220	171	143	265	434
80	10/16	46	49	160	245	127	114	200	200	160	160	19	19	8	8	F05	4x7	90	50	11	30	220	171	143	265	434
100	10/16	52	55	182	280	160	143	220	220	180	180	19	19	8	8	F07	4x9	90	70	14	30	220	171	143	265	434
125	10/16	56	59	207	328	188	170	250	250	210	210	19	19	8	8	F07	4x9	90	70	14	30	220	171	143	265	434
150	10/16	56	59	223	357	210	203	285	285	240	240	23	23	8	8	F07	4x9	90	70	17	30	220	173	153	263	452
200	10/16	60	63	255	418	270	252	340	340	295	295	23	23	12	12	F10	4x12	125	102	17	30	220	173	153	263	452
250	10/16	68	72	314	510	331	306	395	405	350	355	23	28	12	12	F10	4x12	125	102	22	40	220	173	153	265	452
300	10/16	78	82	342	564	372	364	445	460	400	410	23	28	12	12	F10	4x12	125	102	22	45	220	173	153	265	452
350	10/16	78	82	365	640	414	431	505	520	460	470	23	28	16	16	F10	4x12	125	102	22	45	220	173	153	265	475
400	10/16	102	106	410	725	488	480	565	580	515	525	28	31	16	16	F14	4x18	175	140	27	60	220	173	153	265	510

We reserve the rights to modify the production program and the given data without separate notices due to the permanent company development.