

Ball valve for gas
full bore flanged

PN10
PN16

GAS



Ball valve DN50

Product description (standard execution):

- Ball seat made of PTFE interchangeable
- The ball is made of stainless steel in grade 1.4301
- The construction of the valve enables disassembling
- Spindle made of stainless steel improved in grade 1.4021
- NBR or Viton O-ring spindle seal + Teflon ring
- Interchangeable spindle seals
- Corrosion protection according to EN 14901
- Flange connections according to EN 1092-2 (DIN 2501), pressure PN16, PN25, PN40
- Face to face according to producer documentation JAFAR
- Body made of ductile cast iron EN-GJS 350-22-LT
- Product according to EN 13774; EN 1983
- Product marking according to : EN 19; EN 1171

Application:

Gas lines and networks.
Working conditions:
temp. from -30°C up +110°C
pressure up to 4.0 MPa

Execution variant:

For actuator
With electric or pneumatic actuator

Test control:

Water pressure test according to EN 1074-1; EN 1074- 2; EN 12266-1
Body: 1,5 x PN
Air pressure test according to EN 12266-1
Seat: 1,1 x PN
Body: 1,1 x PN
Torque operation test

Accessories:

Pillar with handwheel - see: 9113
Pillar for electric actuator - see: 9114
Street box - see: 9305

Installation:

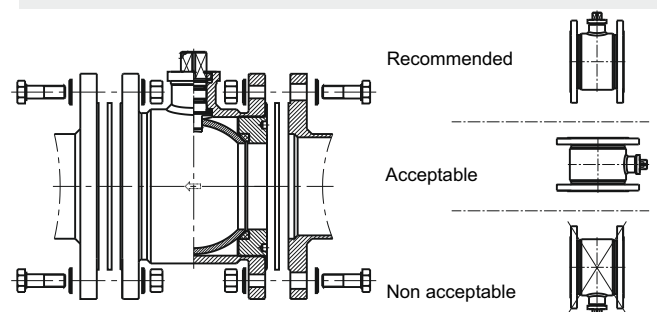

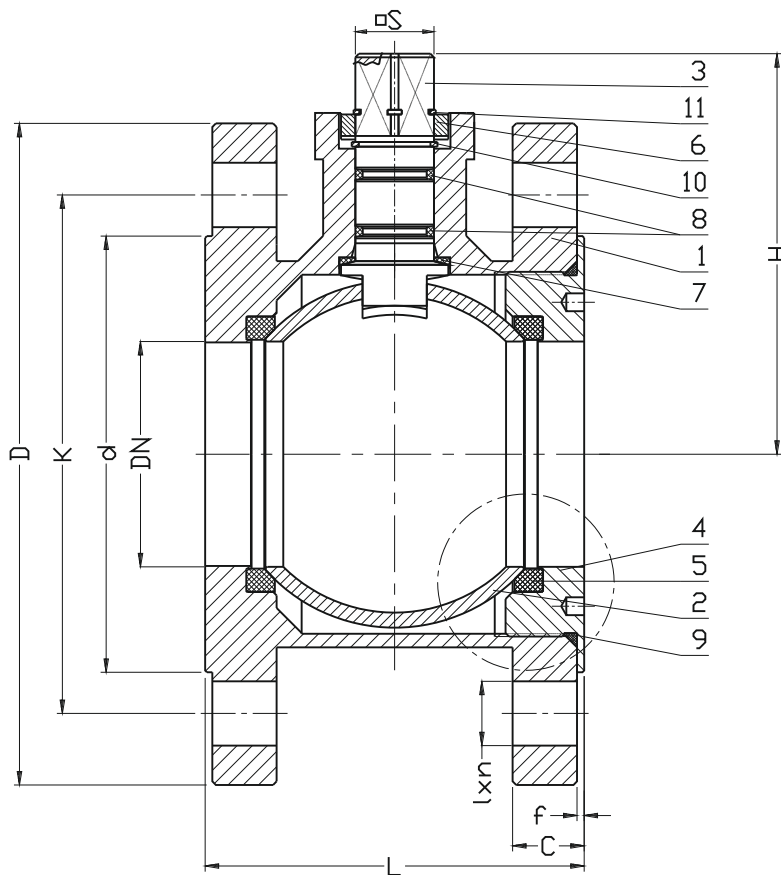

version

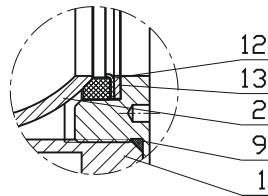

No.	Part	Standard execution
1	Body	Ductile cast iron EN-GJS 350-22 LT EN 1563
2	Ball	Steel 1.4301 EN 10088-1
3	Spindle	Steel 1.4021 EN 10088-1
4	Screw	Steel 1.0037 + Zn EN 10025-2
5	Ball seat	PTFE + C EN ISO 13000-1
6	Limiter	Steel 1.4301 EN 10088-1
7	Gasket	PTFE EN ISO 13000-1
8	O-ring	NBR VITON EN ISO 1629
10	Ring	Steel
11	Ring	Steel
12	Support plate	Steel 1.4301 EN 10088-1
13	Spring	Steel 1.4301 EN 10270-3

DN	L	PN	D	d	K	lxn	H	S	c	f	Kv	Weight
mm	bar	mm	mm	mm	mm	mm	mm	mm	mm	mm	m3/h	kg
ductile cast iron												
40	77	16	150	88	110	4x19	90	11	19	2	105	5,4
50	86	16	165	102	125	4x19	98	17	19	2	163	6,8
65	106	16	185	122	145	8x19	112	17	19	2	275	9,7
80	120	16	200	138	160	8x19	130	22	19	2	418	11,2
100	160	16	220	158	180	8xM16	147	22	19	2	654	17,3
125	186	16	250	188	210	8xM16	164	22	19	2	1023	24,5