

Swing check valve
flanged

PN10
PN16

SEWAGE

WATER



Check flap valve DN80

Product description (standard execution):

- Straight full bore
- Compact design - high tightness
- Maintenance free
- Body, flap and cover made of gray cast iron EN-GJL 250 EN 1560
- Hull ring made of CW617N PN-EN 1412
- Flange connection according to EN 1092-2 (DIN 2501) pressure PN10, PN16
- Face to face row 48 according to EN 558+A1 (DIN3202)
- Body and bonnet made of grey iron EN-GJL 250; EN 1560
- Body-bonnet graphite gasket
- Corrosion protection of epoxy resin coating, minimum 250 microns according to EN 14901
- Body-bonnet zinc coated or stainless steel screws
- Product according to EN 1074-1; EN 1074-3

Application:

Sewage, rainwater, industrial steam and other inert fluids installations with working pressure up to 1.6 MPa and temperature range up to + 82 ° C (NBR rubber seal) up to + 120 ° C (EPDM brass seal)

Test control:

Water pressure test according to EN 1074-1; EN 1074-2; EN 12266-1
Seat: 0,5 to 1,1 xPN
Body: 1,5 x PN

Installation:

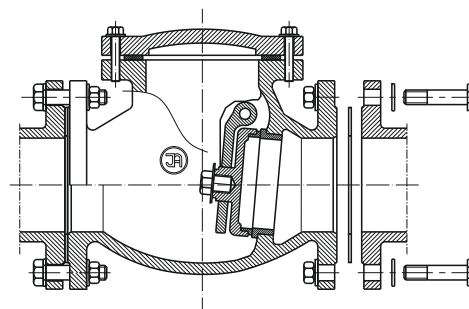

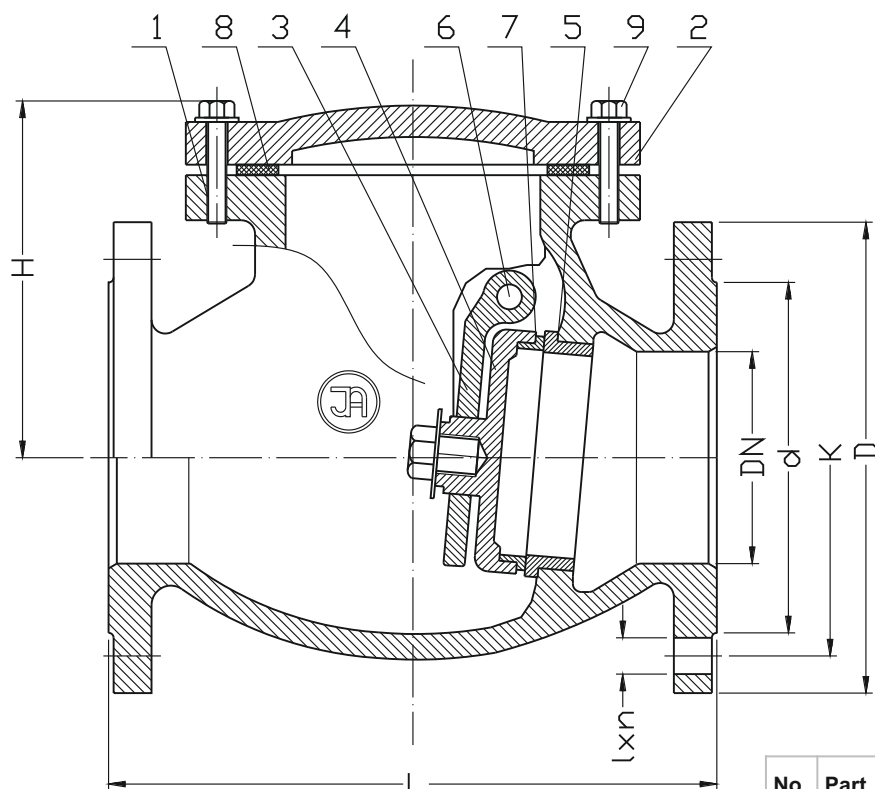

No.	Part	Standard execution
1	Body	Grey iron EN-GJL 250 EN 1560
2	Bonnet	Grey iron EN-GJL 250 EN 1560
3	Lever flap	Ductile cast iron EN-GJS 500-7 EN 1560
4	Flap	Grey iron EN-GJL 250 EN 1560
5	Ring body	Brass CW617N EN 1412
6	Pin flap	Stainless steel 1.4021 EN 10027-2
7	Seat gasket	Rubber EPDM or NBR(*) EN ISO 1629 Brass CW617N EN 1412
8	Gasket	Non-asbestos gasket Graphite
9	Screw	Steel Zn/Fe5 EN-ISO 4017
- other material variants on special request		

DN	PN	L	H	d	D	K	I x n	Weight
[mm]	[bar]	[mm]						[kg]
50	16	200	120	102	165	125	19x4	11
65	16	240	125	122	185	145	19x4	13
80	16	260	147	138	200	160	19x8	17
100	16	300	158	158	220	180	19x8	25
125	16	350	188	188	250	210	19x8	40
150	16	400	193	212	285	240	23x8	50
200	16	500	250	268	340	295	23x8(12)*	58
250	16	600	300	319	405	355	28x12	118
300	16	700	342	370	460	410	28x12	182

*) - 10 bar