

## Flange adaptor RK type multidiameter

PN10  
PN16

WATER

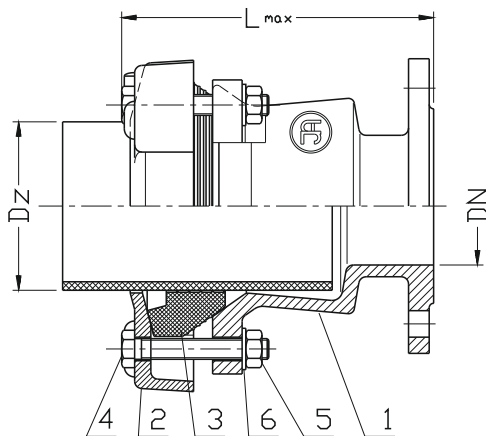

No.	Part	Standard execution
1	Body	Ductile cast iron EN-GJS 500-7 EN 1560
2	Flange	Ductile cast iron EN-GJS 500-7 EN 1560
3	Gasket	Rubber EPDM EN-ISO 1629
4	Screw	Steel Fe/Zn5; Stainless steel A2(*) EN ISO 4017
5	Nut	Steel Fe/Zn5; Stainless steel A4(*) EN ISO 4032
6	Washer	Steel Fe/Zn5; Stainless steel A2(*) EN ISO 7091
(*) - other material variants on special request		

DN	D <sub>2</sub>	Lmax	Weight
	[mm]		[kg]
50	40-75	205	7,7
60 / 65	60-95	205	9,3
80	80-115	205	12,0
100	105-133	200	14,0
125	130-165	250	19,0
150	155-195	250	26,0
175	190-230	275	28,0
200	215-258	275	33,0
225	240-280	290	38,0
250	235-275 / 270-310	290	39,0 / 42,0
300	310-350 / 350-390	290 / 320	50,0 / 55,0
350	350-390 / 395-435	290 / 320	58,0 / 65,0
400	400-435 / 435-470 / 470-505	300 / 330 / 340	70,0 / 76,0 / 81,0
450	455-490 / 490-525	300	80,0 / 83,0
500	505-540 / 540-575 / 575-610	250 / 325 / 325	82,0 / 90,0 / 94,0
600	610-645 / 645-680 / 680-715	250 / 330 / 330	102,0 / 114,0 / 117,0
700	710-745	250	85,0
800	810-845	250	93,0

### Product description (standard execution):

- Flexible positioning of the pipe with a buffer zone
- Acceptable axial deviation up to  $\pm 4^\circ$
- Sealing and strengthening kit
- Connecting the pipe flange with straight naked-end pipes made of different materials: cast iron, PVC etc
- The EPDM elastomer lip seal gasket provides easy and fast installation
- Body and the flange made of ductile cast iron EN-GJS 500-7
- Epoxy coating minimum 250 microns according to EN 14901, GSK RAL certificate
- Product according to EN 14525
- Flange connection according to EN 1092-2 (DIN 2501); pressure PN10; PN16
- Product marking according to EN 19; EN 1074

### Application:

Water line networks: potable water and other chemically inert fluids.  
Connection of straight naked-end pipes made of cast iron, asbestos-cement or PVC to fittings flange.  
Working pressure up to 1.6 MPa, temperature up to +70°C

### Test control:

Water pressure test according to EN 1074-1; EN 12266-1  
Seat: 1,1xPN  
Body: 1,5 x PN