

Flanged eccentric reducer Type FFRE

PN10
PN16

WATER

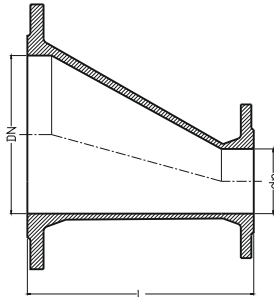

Flanged eccentric reducer Type FFRE 9213

Product description (standard execution):

- Made of ductile cast iron EN-GJS 500-7
- UV resistant epoxy coating EN 14901
- Flange connection according to EN 1092-2 (DIN 2501), pressure PN10, PN16
- Product according to EN 545
- Hygienic certificate PZH for potable water
- Working pressure PN10 / PN16

DN	dn	L	Weight
	[mm]		[kg]
300	150	300	50
400	150	350	70
500	150	400	120
600	200	600	195

Application:

In water supply systems, potable water and other chemically inert liquids as well as raw or industrial sewage

Flanged and socket pieces Type E

PN10
PN16

WATER



Flange and socket pieces E 9217

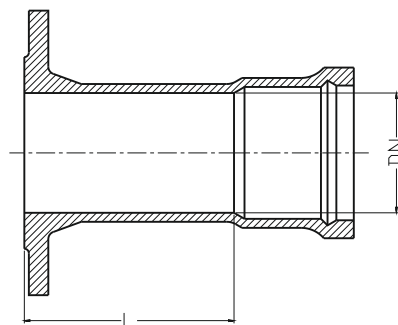

Product description (standard execution):

- Made of ductile cast iron EN-GJS 500-7
- UV resistant epoxy coating EN 14901
- Flange connection according to EN 1092-2 (DIN 2501), pressure PN10, PN16
- Product according to EN 545
- Hygienic certificate PZH for potable water
- Working pressure PN10 / PN16

Application:

In water supply systems, potable water and other chemically inert liquids as well as raw or industrial sewage

DN	L	Weight
	[mm]	[kg]
80	80	9
100	80	11
125	100	15
150	100	18
200	100	24
250	160	35
300	150	45
400	160	67
500	170	82
600	180	110
800	200	210
1000	220	-
1200	240	-

We reserve the rights to modify the production program and the given data without separate notices due to the permanent company development