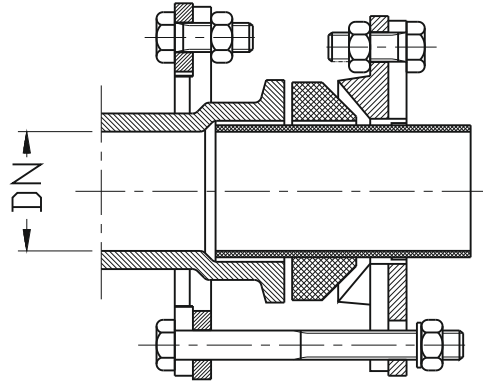

Caulker
PN16
SEWAGE
WATER

Caulker 9101

Product description (standard execution):

- Made of ductile cast iron EN-GJS 500-7
- Galvanized screws
- Gasket: EPDM; NBR; EN-ISO 1629
- Epoxy coating to EN 14901

Application:

Water and sewage networks

DN	Elements	Weight	DN	Elements	Weight
[mm]	[szt]	[kg]	[mm]	[szt]	[kg]
50	2x2	4,8	350	2x4	32,9
80	2x3	7,56	400	2x4	36,75
100	2x3	8,65	500	2x5	49,6
125	2x3	10,25	600	2x6	63,45
150	2x3	11,5	800	2x8	86,6
200	2x4	14,15	1000	2x9	112,7
250	2x4	19,85	1200	2x12	148,8
300	2x4	29,05	-	-	-

Blind flange X
PN16
SEWAGE
WATER

Blind flange 9219

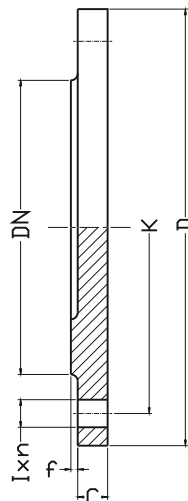
Product description (standard execution):

- Made of ductile cast iron EN-GJS 500-7
- Epoxy coating to EN 14901

Application:

Water and sewage networks

DN	D	K PN16 (PN10)	I PN16 (PN10)	C	f	n PN16 (PN10)	Weight
[mm]						-	[kg]
50	165	125	18	19	3	4	3
80	200	160	18	19	3	8 (4)	4
100	220	180	18	19	3	8	4,5
150	285	240	22	19	3	8	8
200	340	295	22	20	3	12 (8)	11
250	405	355 (350)	26 (22)	22	3	12	17
300	460	410 (400)	26 (22)	24,5	4	12	26
400	580	525 (515)	30 (28)	28	4	16	41
500	715	650 (620)	34 (28)	31,5	4	20	65
600	840	770 (725)	36 (31)	36	5	20	100
800	910	950	43 (35)	43	5	24	207
1000	1255	1170 (1160)	50 (40)	50	5	28	360

We reserve the rights to modify the production program and the given data without separate notices due to the permanent company development