

Street boxes

PN10
PN16

WATER

Box for gate valve; 9501-PEHD-GJL

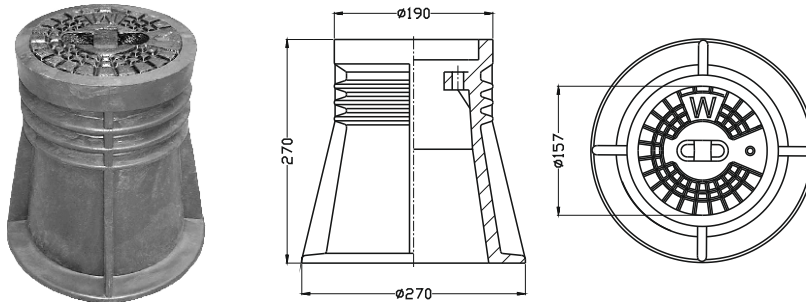

Material	Body PEHD
	Bonnet - Grey iron
Weight	4,0 [kg]
Comment	Dimension by DIN 4055
	Marking on the bonnet "W" EN M-74081

Box for hydrant; 9502-PEHD-GJL

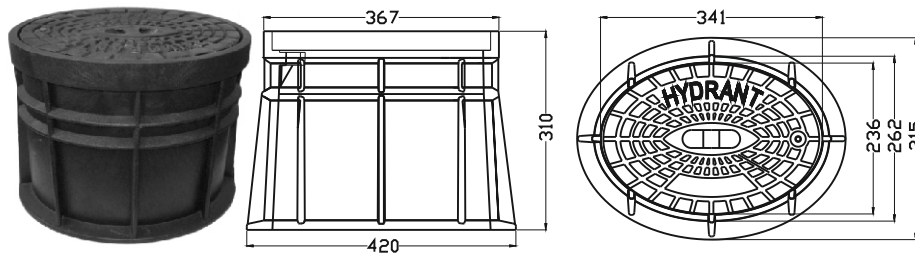

Material	Body PEHD
	Bonnet - Grey iron
Weight	10,0 [kg]
Comment	Dimension by DIN 4055
	Marking on the bonnet HYDRANT EN M-74081

Box for house connectors; 9503-PEHD-GJL

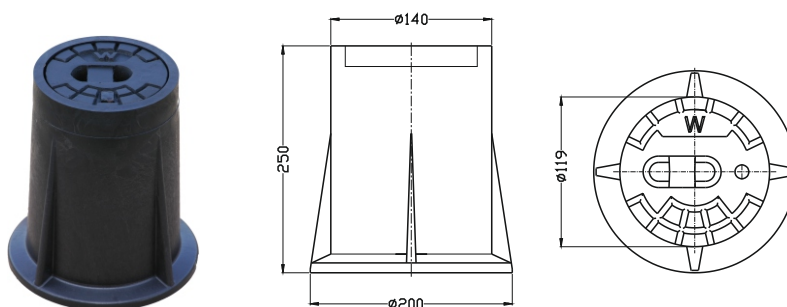

Material	Body PEHD
	Bonnet - Grey iron
Weight	2,5[kg]
Comment	Dimension by DIN 4057
	Marking on the bonnet "W" EN M-74081

Product description (standard execution):

- PEHD body - light weight
- No corrosion; longer service life; no maintenance
- Cover made of gray iron
- High resistance for load
- High positive and negative temperature resistant - frostproof
- Body design provides stable foundation in the ground
- Cover lifting eye

Application:

As an element of underground installation, intended to protect and enhance access to other accessories.

Execution variant:

Stainless steel bolts
Ductile iron covers

Box for gate valve; 9501-GJL-GJL

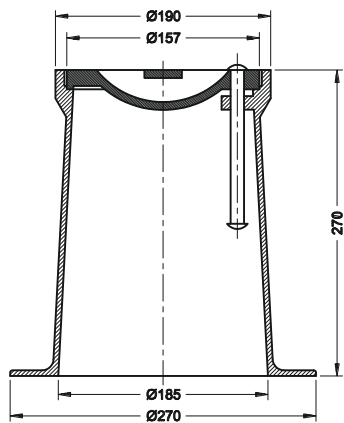

Box for hydrant TYP 4055
Body - grey iron EN-GJL-250; EN 1561
Civer - grey iron EN-GJL-250; EN 1561
ductile cast iron EN-GJS 400-15; EN 1563
cover marking "W"
Weight: 10 kg

Cover lifting eye
Bitumen coating

Box for hydrant; 9502-GJL-GJL

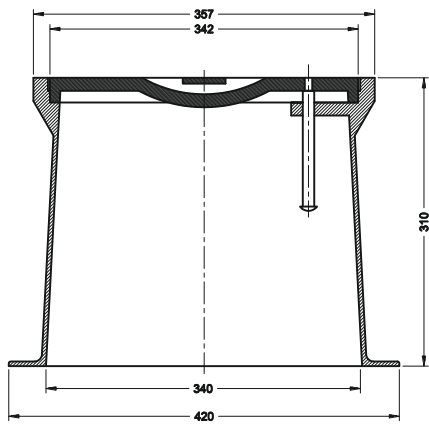

Box for hydrant TYP 4055
Body - grey iron EN-GJL-250; EN 1561
Civer - grey iron EN-GJL-250; EN 1561
ductile cast iron EN-GJS 400-15; EN 1563
cover marking "H"
Weight: 30 kg

Cover lifting eye
Bitumen coating

Box for house connector; 9504-PEHD-GJL; 9504-PEHD-PEHD

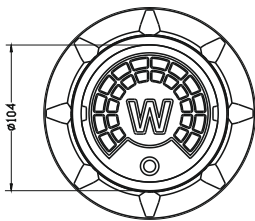
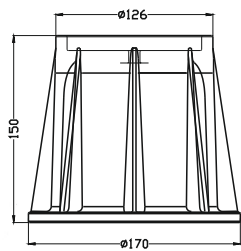

Material	Body PEHD
	Bonnet - Grey iron/PEHD
Weight	1,5/2,0 [kg]
Comment	Marking on the bonnet "W" EN M-74081

Box for house connector H=150; 9504-GJL-GJL

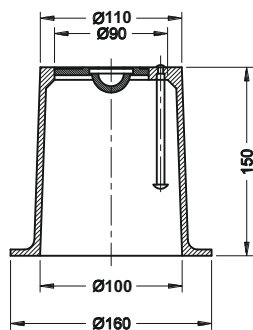

Box for house connector
Body - grey iron EN-GJL 250; EN 1560
Cover - grey iron EN-GJL 250; EN 1560
ductile cast iron EN-GJS 400-15; EN 1560
Weight: 6 kg

Box for gate valve with length regulation; 9509-PEHD-GJL

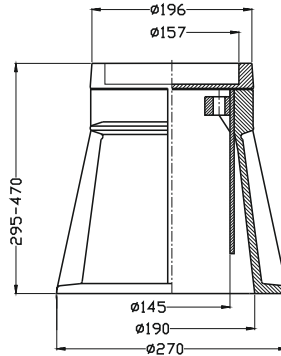

Material	Body PEHD
	Bonnet - Grey iron
Weight	7,9 [kg]
Comment	Dimension by DIN 4056
	Marking on the bonnet "W" EN M-74081

Sleeper plate: 9521-PEHD i 9522-PEHD

To street box:

9501-PEHD-GJL
9503-PEHD-GJL
9504-PEHD-PEHD/GJL
9509-PEHD-GJL

To street box:

9502-PEHD-GJL
9502-GJL-GJL

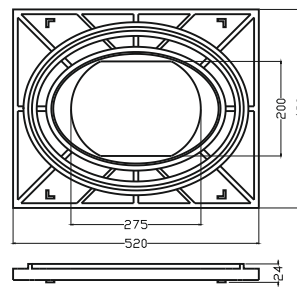
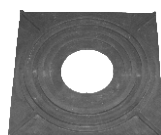
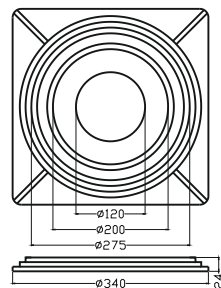

Mounting instruction:

Please check the compatibility with the order before mounting and its intended purpose. Prepare the surface of the hole and pay attention to its depth. Street boxes should be installed directly in natural subsoil or sandy ballast depending on ground conditions.

In order to ensure proper installation it is recommended to use sleeper plate to the street boxes

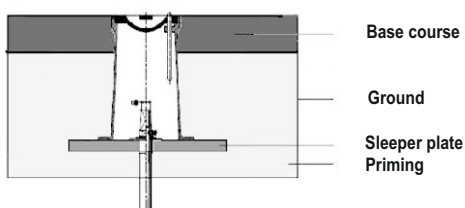

Mounting instruction:

1. Dig a hole
2. Align the excavation bottom, remove large and sharp stones.
3. Prepare layers that are not compacted with sand a thickness of 5 cm
4. Match a sleeper plate to the suitable street box
5. Place the street box in a sleeper plate
6. Gradually sprinkle a sleeper plate layers and compact around the perimeter of the street box.
7. Provide adequate degree of compaction to existing ground conditions and subsequent load external.
8. Enclose the street box by cement or cube