

**Resilient seated gate valve for gas  
flanged**

**PN10  
PN16**

**GAS**



Gate valve 2311 DN500

### Product description (standard execution):

- Body bonnet and wedge made of ductile cast iron EN-GJS 400-15
- Full bore gate valve
- NBR fully vulcanised wedge
- Application of low friction sliding element
- Wedge nut made of forged brass - replaceable
- Stainless steel spindle with rolled thread
- Low friction double spindle bearing acting both horizontal and vertical way
- O-ring spindle sealing packing cork protected against contact with medium
- Packing cork protected against dirt penetration
- Body bonnet Zinc coated screws protected by wax
- Epoxy coating minimum 250 microns according to EN 14901, GSK RAL certificate
- Product according to EN 13774
- Flange connection according to EN 1092-2; (DIN 2501) pressure PN10; PN16
- Face to face according to EN 558-A1 F5 (DIN 3202) – catalogue number 2302
- Face to face according to EN 558-A1 F4 (DIN 3202) – catalogue number 2311
- Product marking according to EN 19; EN 1171

### Application:

Gas lines networks.  
Working conditions:  
temp. from -20°C up +60°C  
pressure up to 1,6 MPa

### Test control:

Water pressure test according to EN 1074-1, EN 1074- 2, EN 12266-1  
Seat: 1,1 x PN;  
Body: 1,5 x PN  
Air pressure test according to EN 12266-1  
Seat: 1,1 x PN;  
Body: 1,1 x PN  
Operation torque test.

### Accessories:

Extension spindle - see: 9006, 9007  
Extension spindle with position indicator - see 9020, 9021  
Pillar with handwheel - see: 9113  
Pillar for electric actuator - see: 9114  
Handwheel - see: 9301  
Street box - see: 9505, 9506, 9507, 9508

### Execution variant:

Ductile cast iron EN-GJS 350-22 LT temp. from -30°C  
SS body and bonnet screws  
With ISO top flange for actuator  
With electric or pneumatic actuator - see: 2931, 2932  
With inductive or electromechanical sensor  
With opening indicator

### Installation:

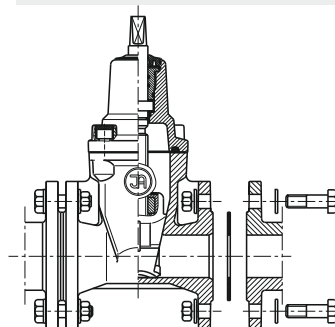

Recommended



Non acceptable

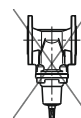

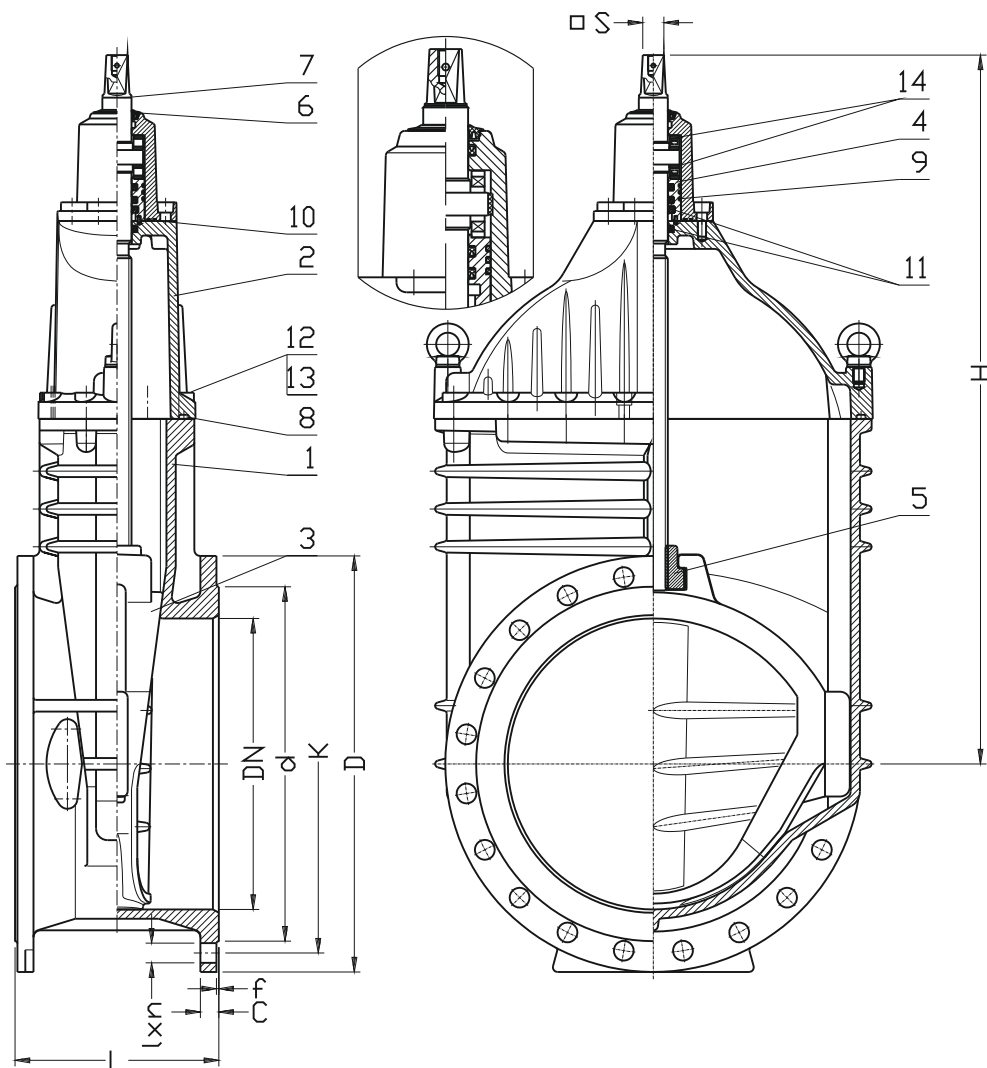

No.	Part	Material	No.	Part	Material
1	Body	Ductile cast iron EN-GJS-400-15 EN-GJS-350-22-LT (*) EN 1563	7	Spindle	Steel 1.4021, 1.4301 (*), 1.4462 (*) EN 10088-1
2	Bonnet	Ductile cast iron EN-GJS-400-15 EN-GJS-350-22-LT (*) EN 1563	8	Body-bonnet gasket	Rubber NBR ISO 1629
3	Wedge + slider	Ductile cast iron EN-GJS-400-15 EN-GJS-350-22-LT (*) EN 1563 Rubber NBR: ISO 1629 Tarnoform 300 EN ISO 1874-1	9,10, 11	O-Ring	Rubber NBR ISO 1629
4	Sealing sleeve	Brass CW617N EN 12165 Bronze CW309G (*) EN12163	12	Screw	Steel Fe/Zn5, stainless steel (*) EN ISO 4762
5	Spindle nut	Brass CW617N EN 12165 Bronze CW309G (*) EN12163	13	Screw stopper	Wax
6	Cleaning gasket	Rubber NBR ISO 1629	14	Bearing	Catalogue producer
(*) - other material variants on special request					

DN	2111 L	2002 L	H	d PN16 (PN10)	D PN16 (PN10)	K PN16 (PN10)	I PN16 (PN10)	C	f	n PN16 (PN10)	Turn for full open	S	Weight [kg]	
[mm]												[mm]	2311	2302
400	310	600	1020	480	580	525 (515)	31 (28)	28	4	16	58	32	298	345
450	330	-	1090	548 (530)	640	585 (565)	31 (28)	30	4	20	65	32	350	-
500	350	700	1220	609 (582)	715 (670)	650 (620)	34 (28)	32	4	20	63	36	458	540
600	390	800	1390	720 (682)	840 (780)	770 (725)	37 (31)	36	5	20	77	36	640	776

We reserve the rights to modify the production program and the given data without separate notices due to the permanent company development.